

Create Batch Hole Training

Create Batch Hole_Training.zip



Create Batch Hole - Overview

Main Functions

- Create multiple holes using custom coordinates.
- Create a new reference coordinates system on a target(selected) face.
- Reset coordinates system and units system.

Benefits

- Creates multiple holes easily.
- Increases work efficiency as creating holes using Hole Wizard



Course Objective: Follow instructions through the course and learn how to use Create Batch Hole.

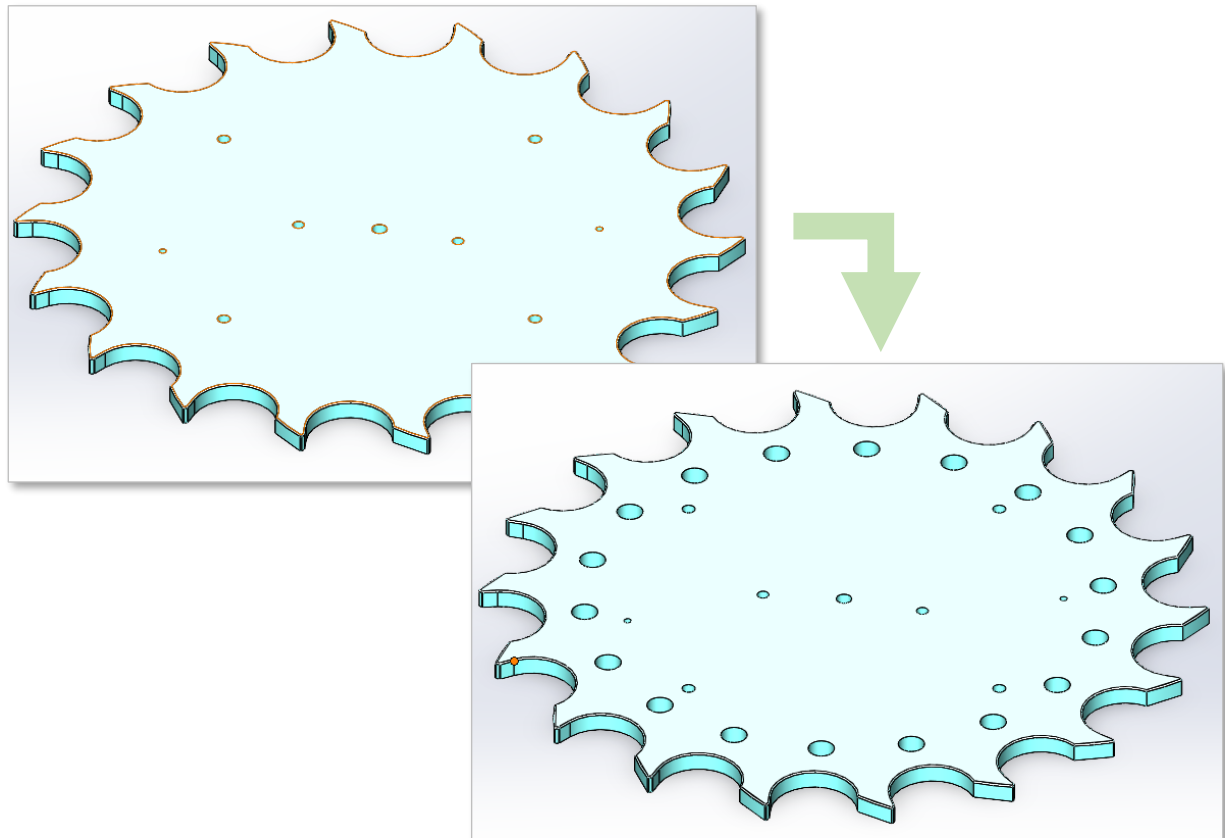
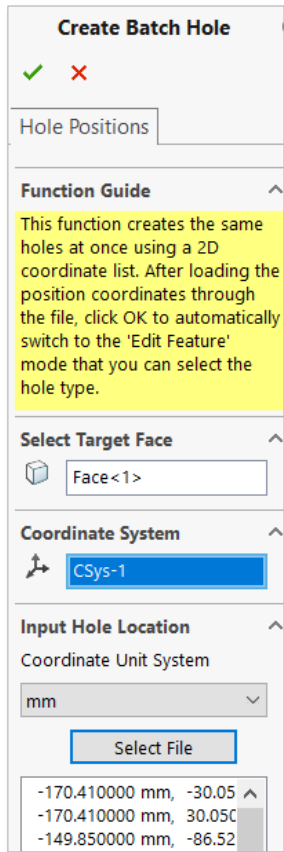

Create Batch Hole - Execute Example File

Work on the part with the red circle (1) following instructions by yourself.
The part with the black square (1) is an additional explanation or a reference.

1 Execute **699-0402.SLDPRT** file among example files.

2 Click **[SpeedWorks]tab - [Create Batch Hole]** button to run the tool.

Name	Date modified	Type	Size
699-0402.SLDPRT	5/17/2021 12:12 PM	SOLIDWORKS Part...	342 KB
Hole_Cordi.txt	7/29/2020 10:51 AM	Text Document	1 KB

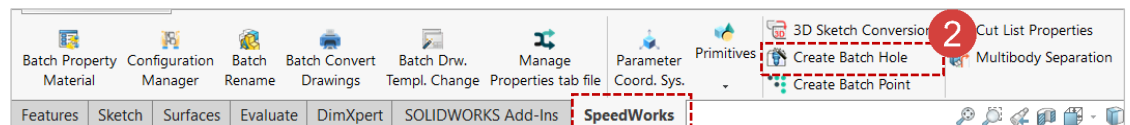
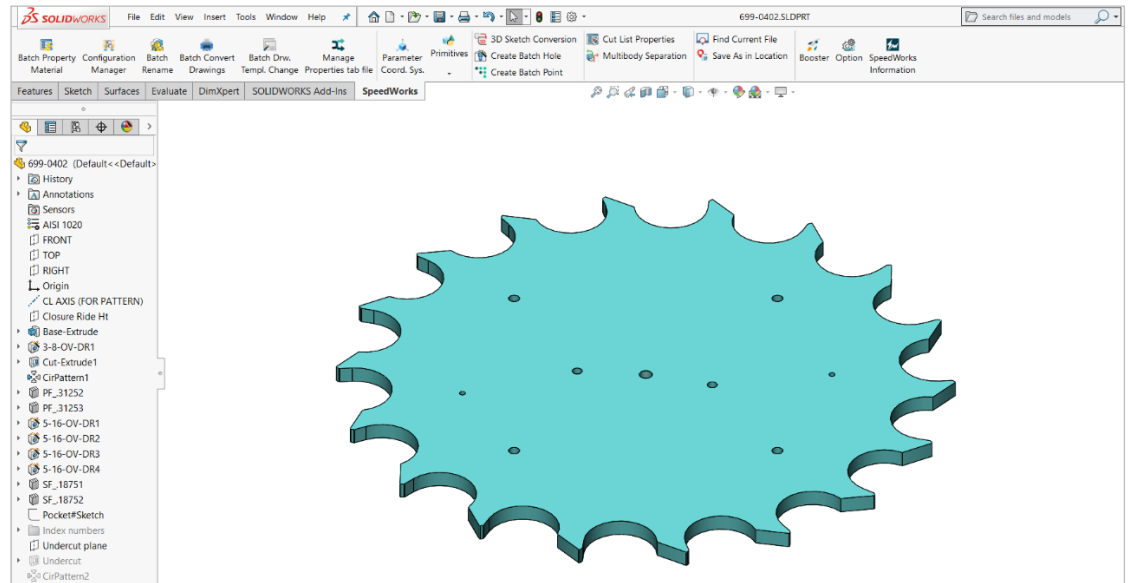

※ You can download example files at Support page in SpeedWorks Homepage(<http://speedworks.info>).

Create Batch Hole - Select Target Face

Work on the part with the red circle (1) following instructions by yourself.
The part with the black square (1) is an additional explanation or a reference.

- 1 Select the face on which holes will be created while **[Select Target Face]** box is activated.

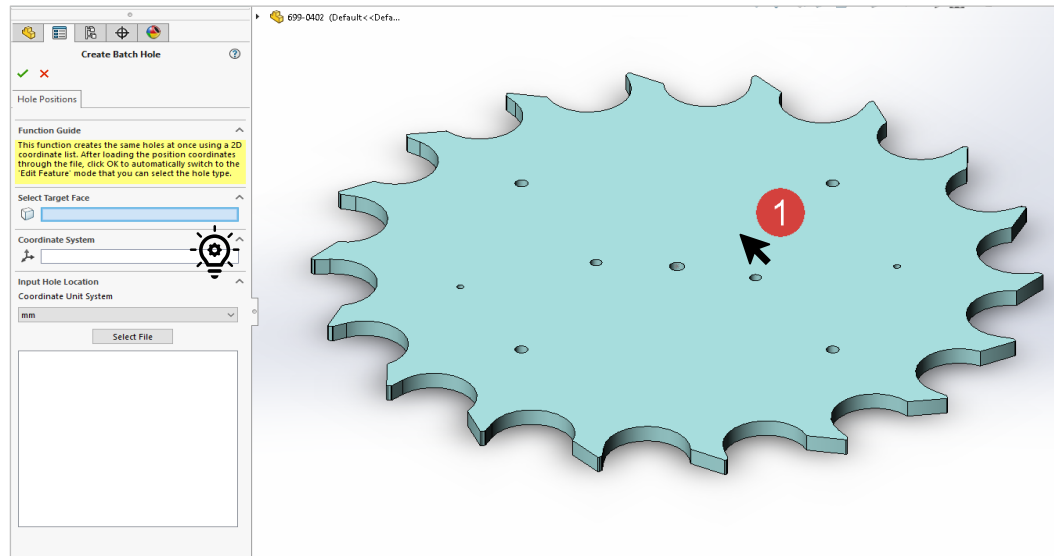

- Once you run Create Batch Hole, Select Target Face box will be automatically activated.

- 1 The name of the selected target face will be displayed.
- 2 The selected target face will be highlighted.

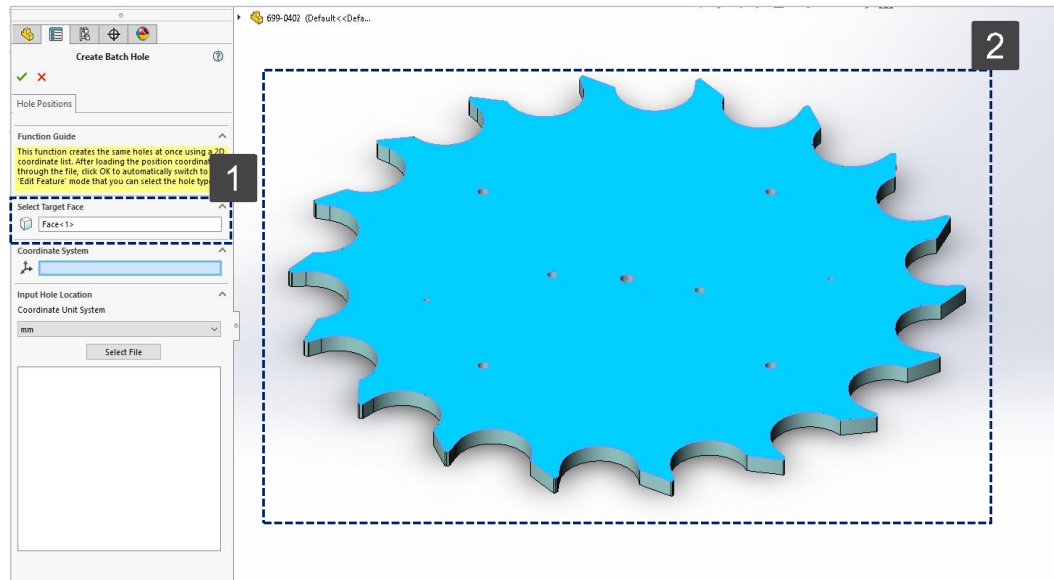

Create Batch Hole - Coordinate System

Work on the part with the red circle (1) following instructions by yourself.
The part with the black square (2) is an additional explanation or a reference.

1 Double-click [Flyout Feature Manager] while [Coordinate System] box is activated.

2 Select 'CSys-1'.

Once you run Create Batch Hole, Coordinate System box will be automatically activated.

1 The name of the selected coordinate system will be displayed.

2 The selected coordinate system will be displayed on the target face.

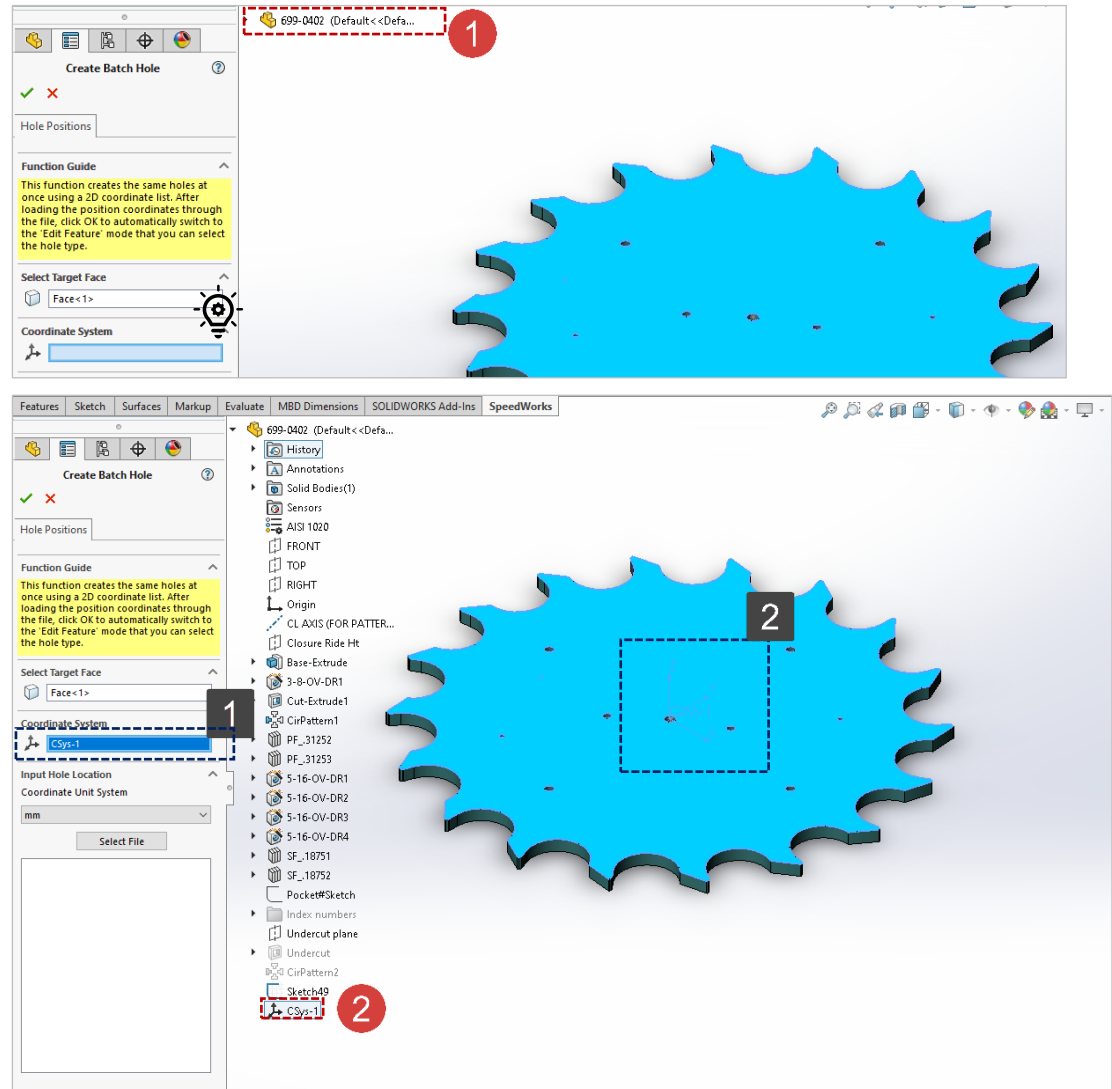

Create Batch Hole - Input Hole Location

Work on the part with the red circle (1) following instructions by yourself.
The part with the black square (2) is an additional explanation or a reference.

- 1 Click **[Select File]** button.
- 2 Select **Hole_Cordi.txt** file.
- 3 Click **[Open]** button to specify a file containing coordinates for each point.
- 4 Select the units system that is identical to the units of the selected data. Select '**mm**' at **[Coordinate Unit System]**.
- 5 Click **[OK]** button. Once you click **[OK]** button, a notification widow will be displayed and Hole Wizard will be activated for you to proceed.

- 1 Once 2D coordinate file is loaded, coordinates will be displayed at the bottom box of **[Select File]**.
- 2 After click **[OK]** button, holes are created as basic shape.

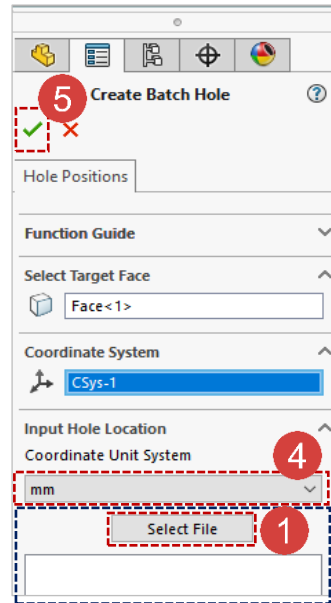

1

```

-170.410000 mm, -30.050000 mm
-170.410000 mm, 30.050000 mm
-149.850000 mm, -86.520000 mm
-149.850000 mm, 86.520000 mm
-111.230000 mm, -132.550000 mm
-111.230000 mm, 132.550000 mm
-59.180000 mm, -162.600000 mm
-59.180000 mm, 162.600000 mm
0.000000 mm, -173.040000 mm
0.000000 mm, 173.040000 mm
59.180000 mm, -162.600000 mm
59.180000 mm, 162.600000 mm
111.230000 mm, -132.550000 mm
111.230000 mm, 132.550000 mm
149.850000 mm, -86.520000 mm
149.850000 mm, 86.520000 mm
170.410000 mm, -30.050000 mm
170.410000 mm, 30.050000 mm
  
```

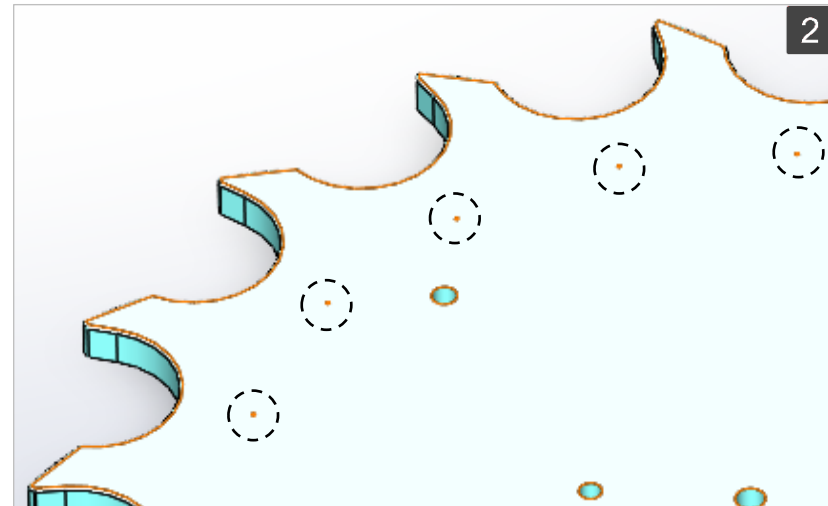
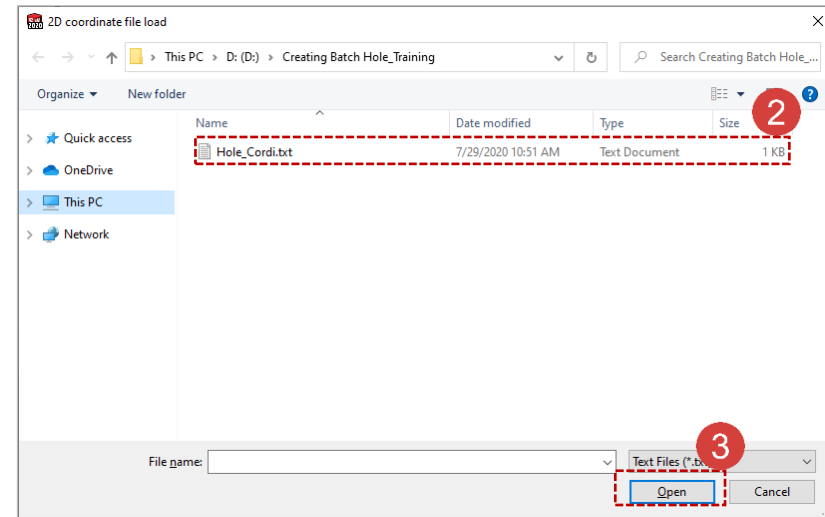

Create Batch Hole - Edit Hole Type

Work on the part with the red circle (1) following instructions by yourself.
The part with the black square (1) is an additional explanation or a reference.

- 1 Click **[OK]** at notice window.

Once you click **[OK]** button, Hole Wizard will be automatically run.

- 2 Specify Hole Type options.

[Hole Type]: Straight Tab

[Standard]: Ansi Metric

[Type]: Tabbed Hole

- 3 Specify Hole Specification option.

[Size]: M10x1.0

- 4 Specify End Condition options.

[End Condition]: Through All

[Thread]: Through All

- 5 Click **[OK]** button.

1 All changes have been applied on every holes as follows.

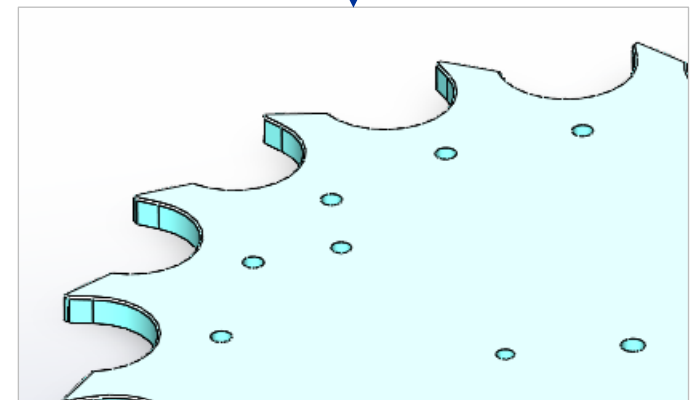
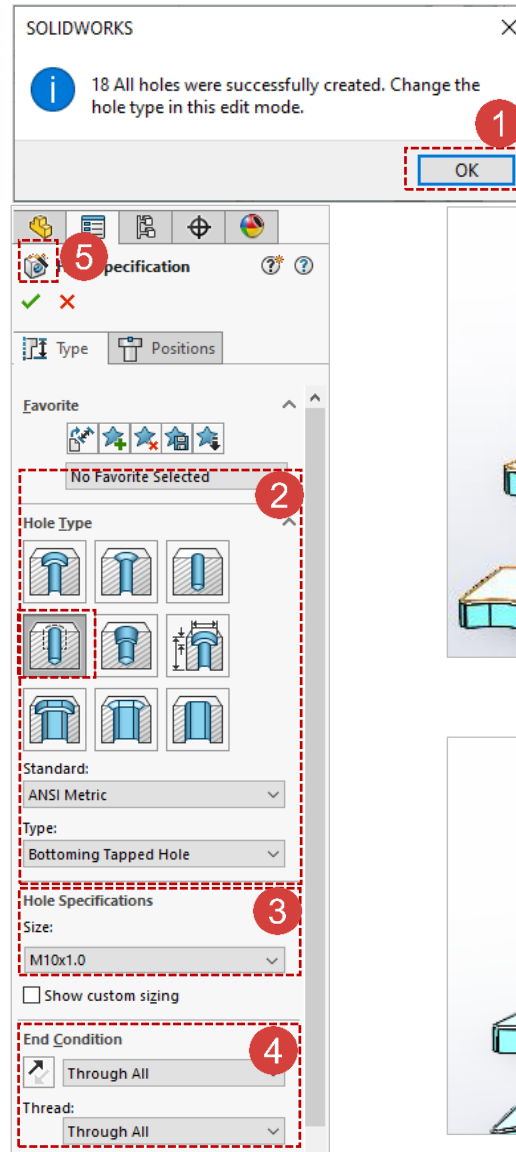

Create Batch Hole - Edit Feature

Work on the part with the red circle (1) following instructions by yourself.
The part with the black square (1) is an additional explanation or a reference.

1 Select a newly created **[BaseHole]** feature and right-click it.

2 Click **[Edit Feature]** button.

3 Change values of Standard and Size.

[Standard]: ISO

[Size]: M20

[Type]: Tabbed Hole

4 Click **[OK]** button.

The holes created in batches are managed as features.

1 All changes have been applied on every hole as follows.

